



Coimisiún na Scrúduithe Stáit
State Examinations Commission

Junior Certificate 2011

Marking Scheme

Technical Graphics

Ordinary Level



Coimisiún na Scrúduithe Stáit
State Examinations Commission

Junior Certificate Examination 2011

Grafaic Theicniúil
Technical Graphics
Ordinary Level

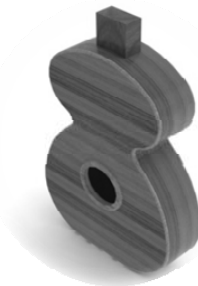

Gnáthleibhéal
Scéim Mharcála

Roinn A agus Roinn B**Section A - Any ten questions from this section**

Q1	4 8	Projection lines from End Elevation (2 × 2 marks) Elevation– 4 lines – 2 marks per line (4 × 2 marks)
Q2	8 4	For a good quality, well proportioned freehand pictorial sketch (5 average quality or rule used) For colour or shading
Q3	6 6	A- Correct Name and Use (3 marks +3 marks) B- Correct Name and Use (3 marks +3 marks)
Q4	4 8	Semi-circle (4 marks) Drawing lines stem and base (4 × 2 marks)
Q5	6 6	Correct location of F1 (6 marks) Arc AOB (6 marks)
Q6	7 5	14 Lines half mark per line (7 marks) For colour or shading (5 marks)
Q7	12	19-21 sq. metres = 12 marks (18 or 22 = 8 marks)
Q8	6 6	A = 2.0m (6 marks) B = 1.2m (6 marks)
Q9	8 4	Elevation of blocks – 4 rows 2 marks for each row correct (-1 mark each row incorrect) Good proportion
Q10	6 6	Line AB (6 marks) Line BC (6 marks)
Q11	6 6	Correct command (6 marks) Correct command (6 marks)
Q12	4 8	1 mark for each projection line to vertical plane 8 marks for correct outline (4 marks for incomplete outline)
Q13	6 6	A = Octagon (6 marks) B = 45 (6 marks)
Q14	12	6 lines – 2 marks per line in perspective view (6 × 2 mark)
Q15	6 6	Correct angle of rotation of handle (6 marks) Complete handle 2 lines and arc (3 × 2 marks)
Total 120		

Section B

Ceist 1: Orthographic Projection

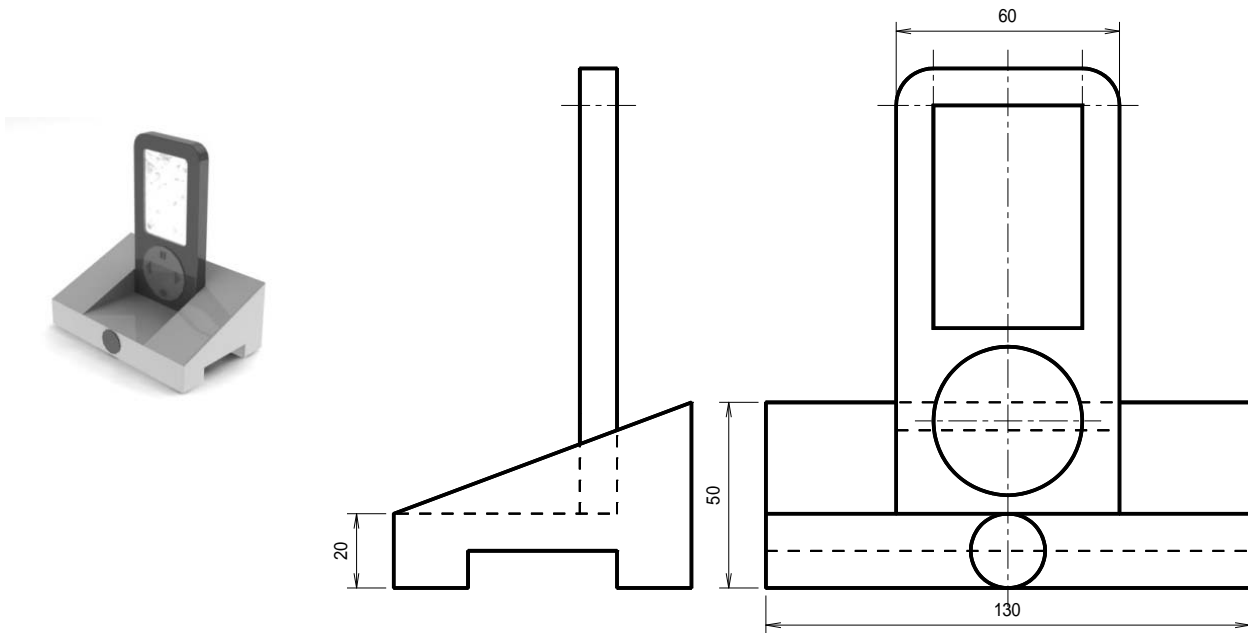

Orthographic Outline (10)	
10	Elevation and end elevation positioned correctly <i>(4 if not aligned or incorrect side, 1 view = 3 marks)</i>
Elevation (25)	
9	Dock Outline 6 lines and circle <i>(6 × 1 mark + 3 marks)</i>
13	MP3 Player outline 3 lines and 2 radii <i>(5 × 1 mark)</i> Screen and circle <i>(4 × 1 mark + 4 marks)</i>
3	Hidden detail <i>(3 × 1 mark)</i>
End Elevation (19)	
10	Dock Outline 7 lines and sloping line <i>(7 × 1 mark + 3 marks)</i>
6	MP3 Player outline <i>(3 × 2 marks)</i>
3	Hidden detail <i>(3 × 1 mark)</i>
Dimension lines (4)	
4	1 mark per dimension line <i>(4 × 1 mark)</i>
(12)	Drafting, accuracy and presentation
Total 70	

Ceist 2: Ellipse

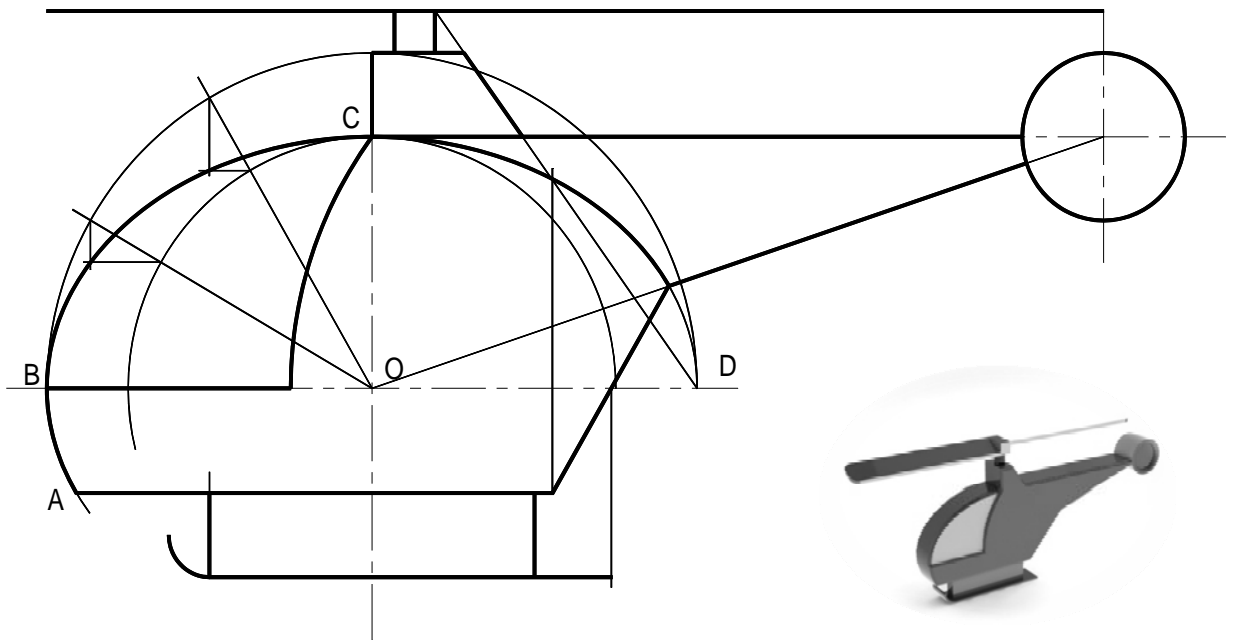

Body Construction (35)	
6	Semi-Ellipse ; Major BD ; Semi- minor OC – (2 × 3 marks)
10	Construction for semi-ellipse (<i>incorrect application = 4 marks</i>)
8	Drawing curve of ellipse ABCD (8,6,4, <i>depending on quality</i>)
5	Arc from D (3marks) horizontal line (2 marks)
6	Base line (3 marks) back angle line (3 marks)
Landing Gear (8)	
8	3 Lines and arc (4 × 2 marks)
Tail (7)	
7	2 Lines and circle (2 × 2 marks + 3 marks)
Top (8)	
3	Sloping line (3 marks)
5	5 lines (5 × 1 mark)
(12)	Drafting, accuracy and presentation
Total 70	

Ceist 3: Surface Development

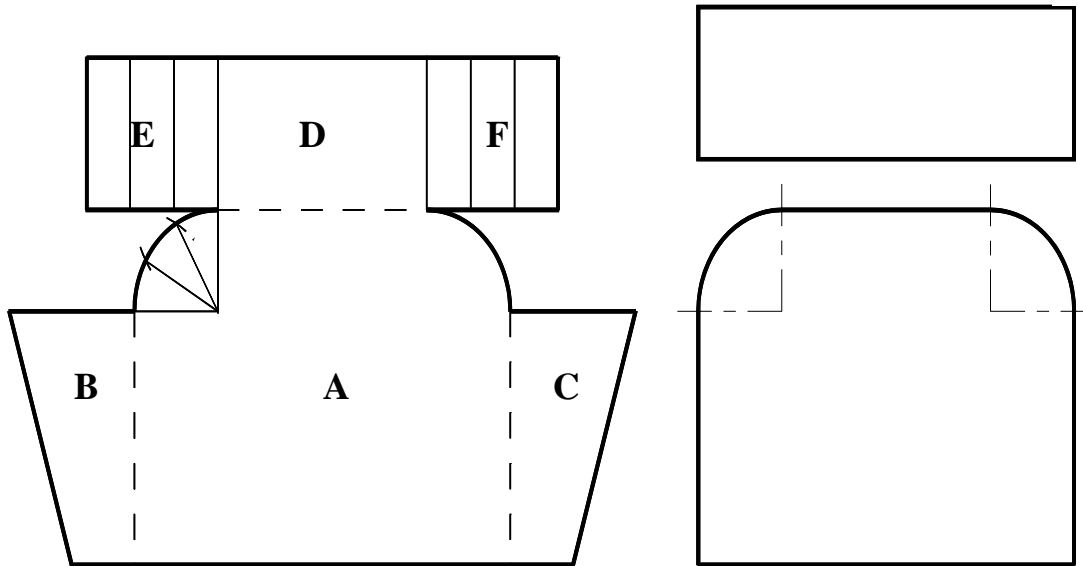

Orthographic (20)	
4	Elevation and plan in correct position <i>(Plan in wrong location 2 marks)</i>
8	Elevation - 4 lines <i>(4 × 2 marks)</i>
8	Plan – 4 lines and 2 radii <i>(4 × 1 marks + 2 × 2 marks)</i>
Development (38)	
8	Base A - 4 lines and 2 radii <i>(4 × 1 mark + 2 × 2 marks)</i>
12	Side B and Side C - 3 lines <i>(3 × 2 marks)</i> - 3 lines <i>(3 × 2 marks)</i>
3	Side D - 3 lines <i>(3 × 1 mark)</i>
6	Construction for finding correct length of sides E and F
6	Side E and Side F - 3 lines <i>(3 × 1 marks)</i> - 3 lines <i>(3 × 1 mark)</i>
3	Fold lines <i>(3 × 1 mark)</i>
(12)	Drafting, accuracy and presentation
Total 70	

Ceist 4: Isometric Projection

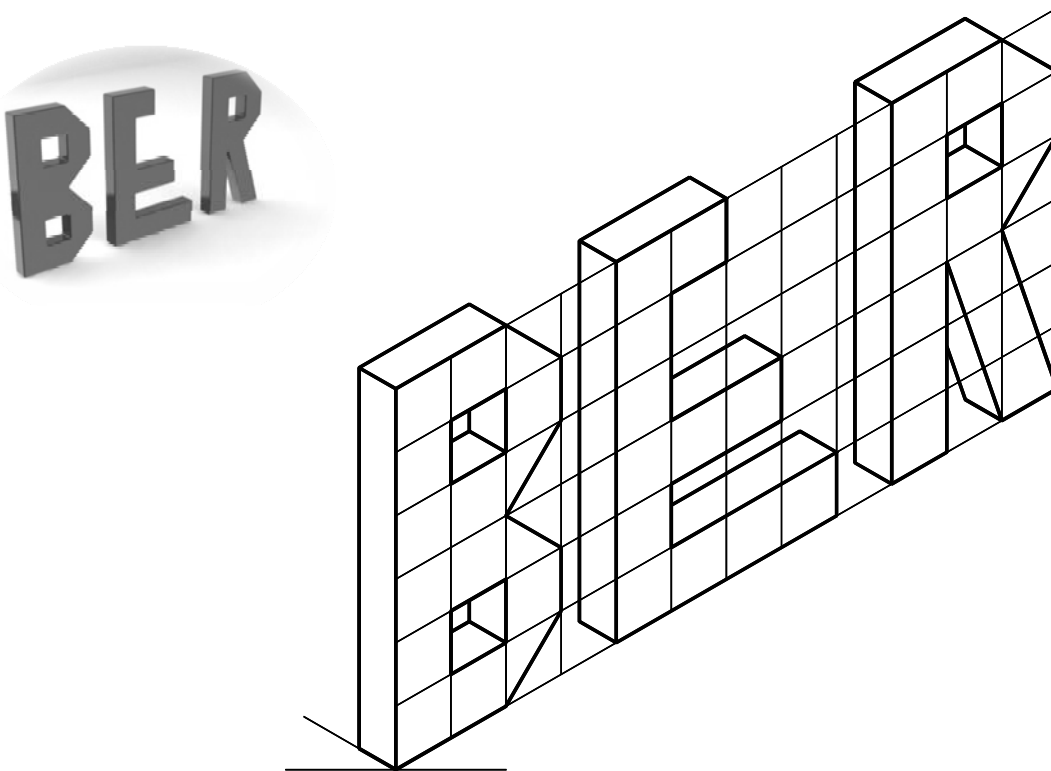

Setting Up (15)	
9	Height, length and width of grid (<i>3 × 3 marks</i>) (<i>deduct 2 marks each if inaccurate</i>)
6	Isometric outline (<i>deduct 3 + 3 marks if 30° angles are not used</i>)
Front Face (22)	
9	Letter B – 17 lines (half mark each line)
6	Letter E – 12 lines (half mark each line)
7	Letter R – 14 lines (half mark each line)
Complete width (21)	7 marks per letter (<i>4 marks per letter if all lines are not included</i>)
(12)	Drafting, accuracy and presentation
Total 70	

Ceist 4: Oblique Projection

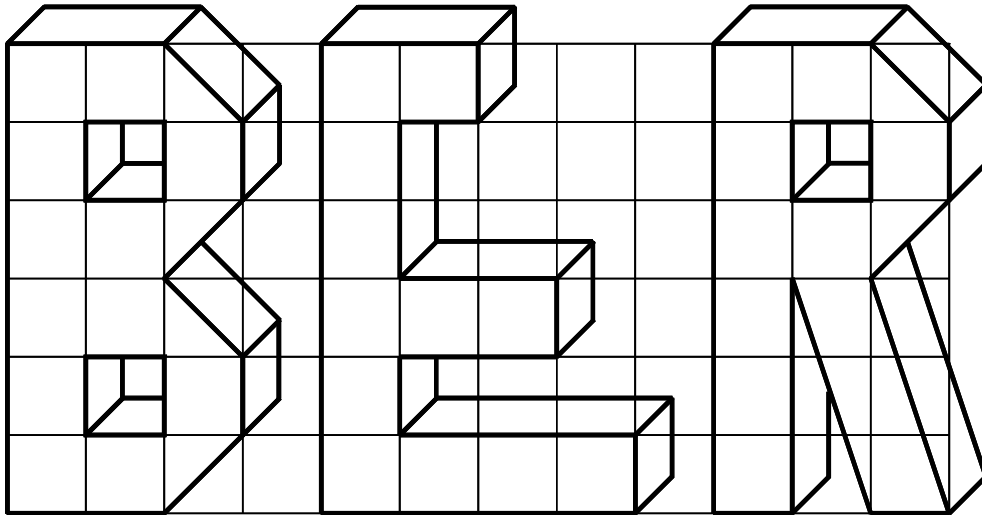

Setting Up (15)	
9	Height, length and width of grid (<i>3 × 3 marks</i>) (<i>deduct 2 marks each if inaccurate</i>)
6	Oblique outline (<i>deduct 6 marks if 45° angle not used</i>)
Front Face (22)	
9	Letter B – 17 lines (half mark each line)
6	Letter E – 12 lines (half mark each line)
7	Letter R – 14 lines (half mark each line)
Complete width (21)	7 marks per letter (<i>4 marks per letter if all lines are not included</i>)
(12)	Drafting, accuracy and presentation
Total 70	

Ceist 5 Transformation Geometry

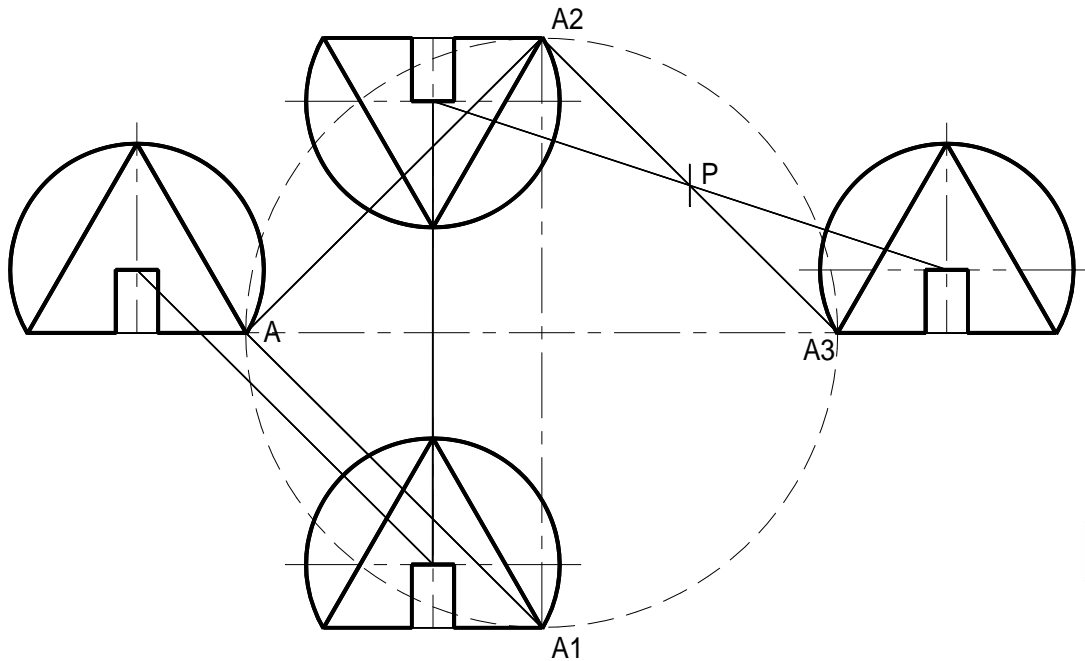

Setting up (16)	
10	Draw given fig ; Circle - 4 marks Triangle - 3 × 1 mark Doorway - 3 × 1 mark
4	Locating points A, A1, A2, A3 (4 × 1 mark)
2	Locating point P
Translation (14)	
4	Drawing 4 lines parallel to A-A1 (correct position and orientation)
10	Drawing fig. as above
Axial Symmetry (14)	
4	Projection lines perpendicular to A-A3
10	Drawing fig. as above
Central Symmetry (14)	
4	Drawing lines through centre point P
10	Drawing Fig. as above
(12)	Drafting, accuracy and presentation
Total 70	

Ceist 6 – Circles and tangents

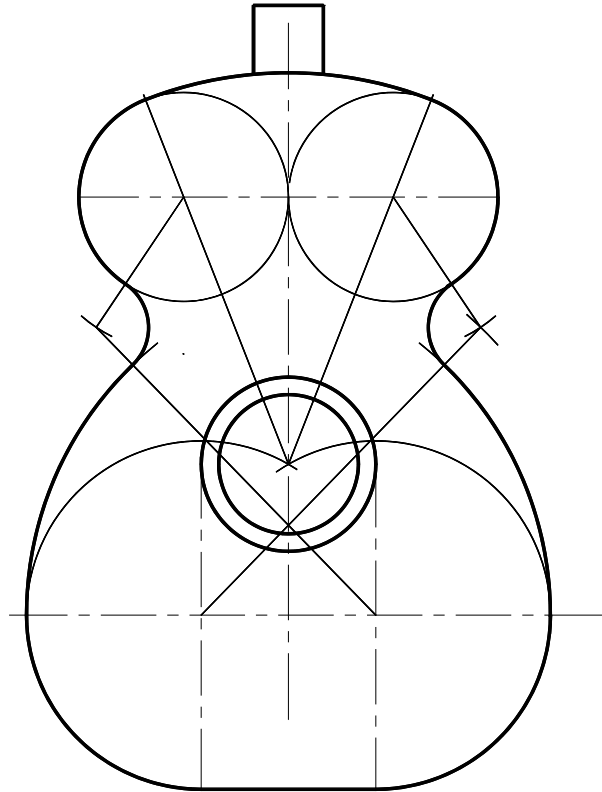

Outline Construction(17)	
6	Top r 30 circles (<i>2 × 3 marks</i>)
5	Offset 120mm and offset 50mm (<i>3 marks + 2 marks</i>)
6	Base r 50 circles(<i>2 × 3 marks</i>)
Base Completion(34)	
8	Centre location and 2 circles(<i>2 marks + 2 × 3 marks</i>)
10	R100 Arcs and base line (<i>2 × 4 marks + 2 marks</i>)
8	R15Arc - Location (<i>2 marks</i>) POCs (<i>2 × 1 marks</i>) Arc (<i>4marks</i>)
8	R15Arc - Location (<i>2 marks</i>) POCs (<i>2 × 1 marks</i>) Arc (<i>4marks</i>)
Top Completion (7)	
4	Top arc and POCs (<i>2 × 2 marks</i>)
3	3 lines (<i>3 × 1 mark</i>)
(12)	Drafting, accuracy and presentation
Total 70	