

Friday 18 May 2012 – Afternoon

AS GCE HEALTH AND SOCIAL CARE

F913/01 Health and Safety in Care Settings

Candidates answer on the Question Paper.

OCR supplied materials:

None

Other materials required:

None

Duration: 1 hour 30 minutes



Candidate forename		Candidate surname	
Centre number		Candidate number	

MODIFIED LANGUAGE

INSTRUCTIONS TO CANDIDATES

- Write your name, centre number and candidate number in the boxes above. Please write clearly and in capital letters.
- Use black ink. HB pencil may be used for graphs and diagrams only.
- Answer **all** the questions.
- Read each question carefully. Make sure you know what you have to do before starting your answer.
- Write your answer to each question in the space provided. If additional space is required, you should use the lined pages at the end of this booklet. The question number(s) must be clearly shown.
- Do **not** write in the bar codes.

INFORMATION FOR CANDIDATES

- The number of marks is given in brackets [] at the end of each question or part question.
- The total number of marks for this paper is **100**.
- You will be awarded marks for the quality of written communication where an answer requires a piece of extended writing.
- This document consists of **20** pages. Any blank pages are indicated.



A



B

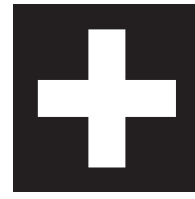

C

(a) (i) Identify each of the signs above.

A

B

C [3]

(ii) Identify the **type** of sign.

..... [1]

(iii) What should be the background colour of sign C?

..... [1]

(iv) Name the legislation that controls the use of these and other signs.

..... [1]

- 2 (a) Identify **three** pieces of information that should be present on an accident report form. Describe why each piece of information is important.

1

.....

.....

.....

2

.....

.....

.....

3

.....

.....

..... [6]

- (b) (i) Name **one** piece of equipment that a practitioner could use to move a person.

..... [1]

- (ii) Explain **four** steps that a practitioner should take before using this piece of equipment.

1

.....

.....

.....

2

.....

.....

.....

3

.....

.....

.....

4

.....

.....

..... [8]

[Total: 15]

Plan of Childminder's Home

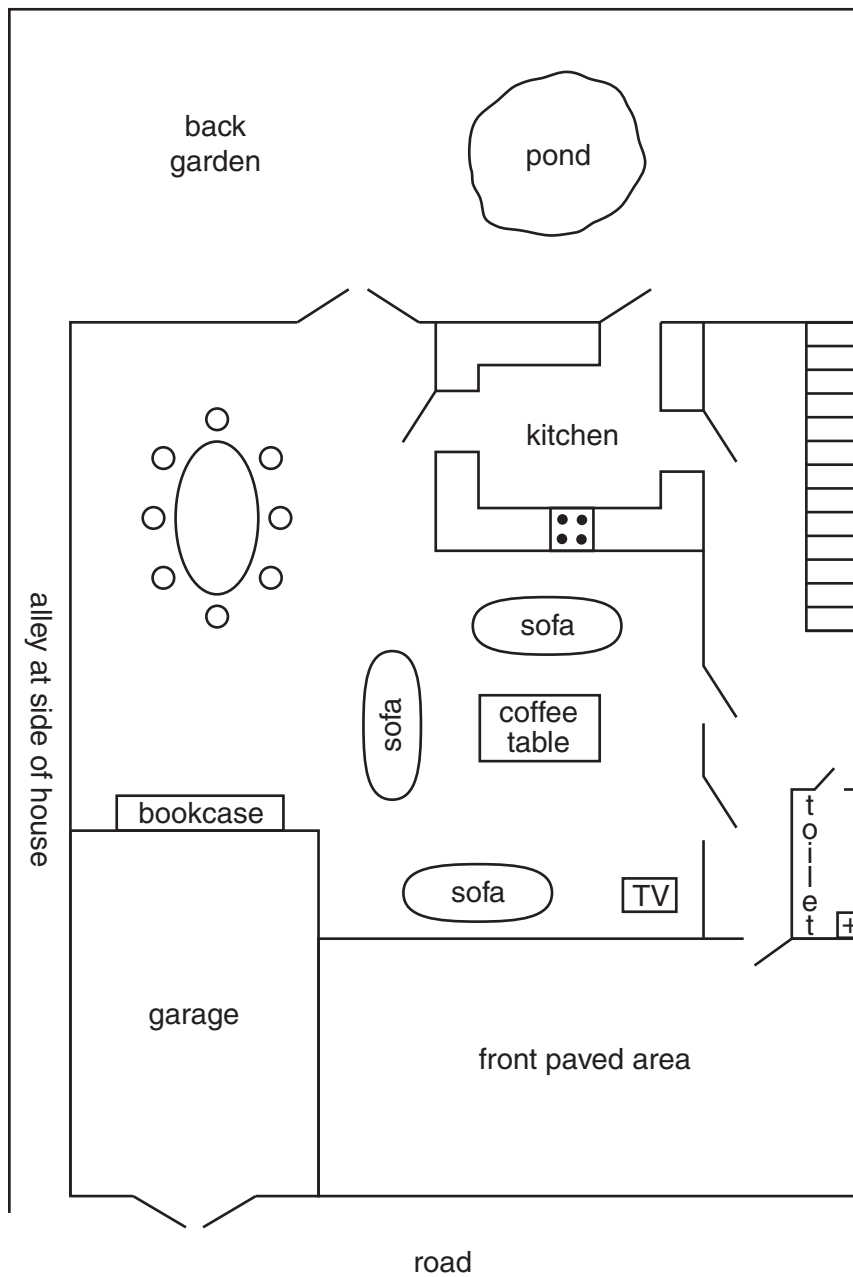

Key



cooker



stairs to upper storey



door



first aid box



table and chairs

[illegible]

.....

.....

.....

..... [15]

- (b) The fourth stage of risk assessment is to record the findings.

Evaluate the importance of this stage to practitioners in a care setting.

.....

.....

.....

.....

.....

.....

.....

.....

.....

.....

..... [5]

[Total: 20]

- 4 (a)** Explain the precautions to reduce the spread of fire in a care setting.

..... [10]

Nursery

..... [10]

[Total: 20]

- 5 (a)** Explain how a practitioner maintains their personal safety when dealing with clinical waste and instruments.

..... [8]

..... [7]

[Total: 15]

- 6 (a)** Explain how the security of people who use services should be protected in a care setting.

..... [7]

(b) Discuss the roles of the Health and Safety Executive.

[8]

[Total: 15]

This image shows a full page of white paper with horizontal dotted lines. The lines are evenly spaced and run across the width of the page, providing a guide for handwriting practice. There are no margins, text, or other markings on the page.

PLEASE DO NOT WRITE ON THIS PAGE



Copyright Information

OCR is committed to seeking permission to reproduce all third-party content that it uses in its assessment materials. OCR has attempted to identify and contact all copyright holders whose work is used in this paper. To avoid the issue of disclosure of answer-related information to candidates, all copyright acknowledgements are reproduced in the OCR Copyright Acknowledgements Booklet. This is produced for each series of examinations and is freely available to download from our public website (www.ocr.org.uk) after the live examination series.

If OCR has unwittingly failed to correctly acknowledge or clear any third-party content in this assessment material, OCR will be happy to correct its mistake at the earliest possible opportunity.

For queries or further information please contact the Copyright Team, First Floor, 9 Hills Road, Cambridge CB2 1GE.

OCR is part of the Cambridge Assessment Group; Cambridge Assessment is the brand name of University of Cambridge Local Examinations Syndicate (UCLES), which is itself a department of the University of Cambridge.